

# WHITE OAK TOWNSHIP, T.2N. - R.2E. , INGHAM COUNTY, MICHIGAN

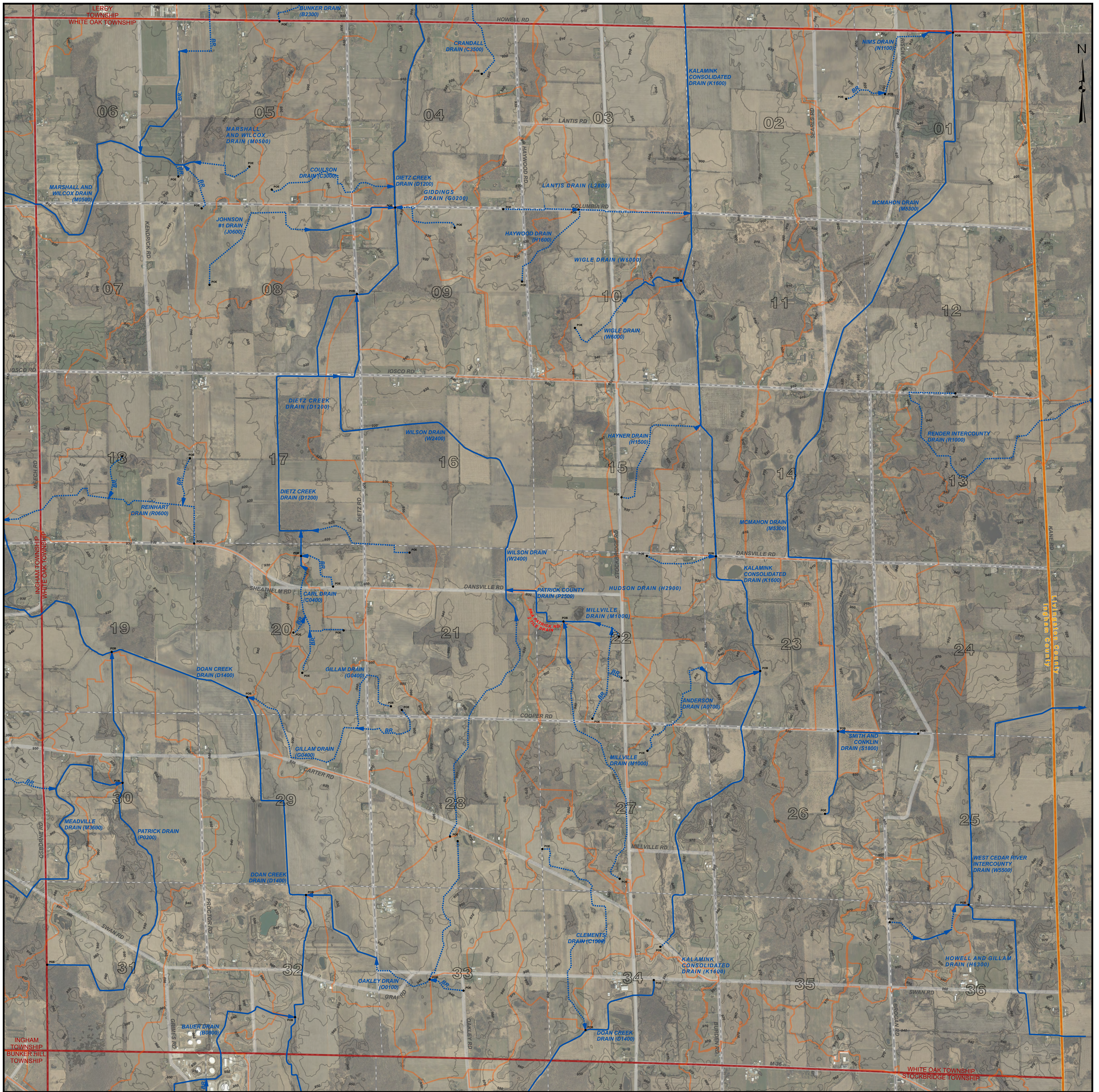

PATRICK E. LINDEMANN  
INGHAM COUNTY DRAIN COMMISSIONER

**PRELIMINARY**

WHITE OAK TOWNSHIP DRAIN MAP  
T.2N. - R.2E.  
INGHAM COUNTY, MICHIGAN



**LEGEND**

- MUNICIPAL BOUNDARIES
- SECTIONS
- COUNTY
- DRAINAGE DISTRICT BOUNDARIES
- OPEN DRAIN
- CLOSED DRAIN
- ROADS
- RAILROADS
- NATURAL WATERCOURSE

RED = FORMERLY KNOWN AS

**DISCLAIMER:**  
This map is a generalized representation of established drain routes and courses of drainage district boundaries. It is provided by the Ingham County Drain Commissioner for reference and display purposes only and does not confirm, create, refute, remove, expand, alter or otherwise affect any rights or obligations recognized or imposed by federal, state or local law, ordinance, regulation or rule.

0 0.25 0.5 1 Miles

1 INCH = 1,000 FEET

**DRAIN INDEX**

DRAIN NO	DRAIN NAME	DRAIN NO	DRAIN NAME	DRAIN NO	DRAIN NAME
A0700	ANDERSON DRAIN	H1500	HAYNER DRAIN	N1100	NIMS DRAIN
B0800	BAUER DRAIN	H1600	HAYWOOD DRAIN	O0100	OAKLEY DRAIN
B2300	BUNKER DRAIN	H2900	HUDSON DRAIN	P0200	PATRICK DRAIN
C0400	CARL DRAIN	H6300	HOWELL AND GILLAM DRAIN	P1800	PROBSTAL DRAIN
C1500	CLEMENTS DRAIN	J0900	JOHNSON #1 DRAIN	P2500	PATRICK COUNTY DRAIN
C3000	COULSON DRAIN	K1600	KALAMINK CONSOLIDATED DRAIN	R0600	REINHART DRAIN
C3500	CRANDALL DRAIN	L2800	LANTIS DRAIN	R1000	RENDER INTERCOUNTY DRAIN
D1200	DIETZ CREEK DRAIN	M0500	MARSHALL AND WILCOX DRAIN	S1800	SMITH AND CONKLIN DRAIN
D1400	DOAN CREEK DRAIN	M1000	MILLVILLE DRAIN	W2400	WILSON DRAIN
G0200	GIDDINGS DRAIN	M3600	MEADVILLE DRAIN	W5500	WEST CEDAR RIVER INTERCOUNTY DRAIN
G0400	GILLAM DRAIN	M5300	MCMAHON DRAIN	W6000	WIGLE DRAIN