

ONONDAGA TOWNSHIP, T.1N. - R.2W. , INGHAM COUNTY, MICHIGAN

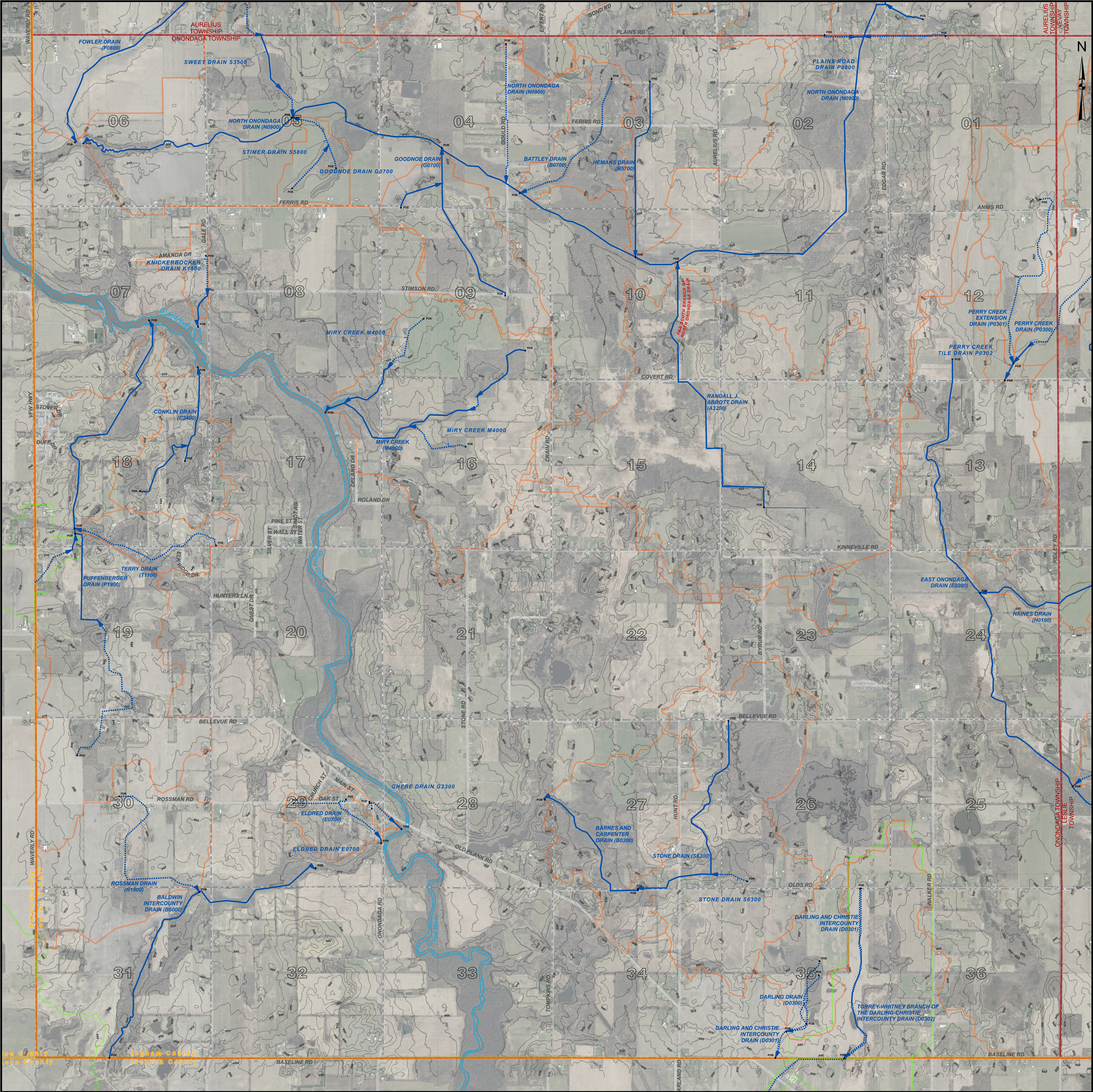

PATRICK E. LINDEMANN  
INGHAM COUNTY DRAIN COMMISSIONER

PRELIMINARY

ONONDAGA TOWNSHIP DRAIN MAP  
T.1N. - R.2W.  
INGHAM COUNTY, MICHIGAN

INGHAM COUNTY



DRAIN COMMISSIONER  
PATRICK E. LINDEMANN

707 BURL AVENUE  
P.O. BOX 220  
MASON, MI 48854  
PHONE: (517)-676-8395  
FAX: (517)-676-8364

LEGEND

MUNICIPAL BOUNDARIES

SECTIONS

COUNTY

DRAINAGE DISTRICT BOUNDARIES

OTHER INTERCOUNTY DISTRICT BOUNDARIES

OPEN DRAIN

CLOSED DRAIN

ROADS

RAILROADS

NATURAL WATERCOURSE

RED = FORMERLY KNOWN AS

DISCLAIMER:

This map is a generalized representation of established drain routes and courses and/or drainage district boundaries. It is provided by the Ingham County Drain Commissioner for reference and display purposes only and does not confirm, create, refute, remove, expand, alter or otherwise affect any rights or obligations recognized or imposed by federal, state or local law, ordinance, regulation or rule.

00.250.51Miles

1 INCH = 1,000 FEET

DRAIN INDEX	
Drain No.	Drain Name
A3200	RANDALL J. ABBOTT DRAIN
B0200	BARNES AND CARPENTER DRAIN
B0700	BATTLE DRAIN
B6000	BALDWIN INTERCOUNTY DRAIN
C1200	CLARKE JOINT DRAIN
C4000	CONKLIN DRAIN
D0300	DARLING DRAIN
D0301	DARLING AND CHRISTIE INTERCOUNTY DRAIN
D0302	TORREY-WHITNEY BRANCH OF THE DARLING-CHRISTIE INTERCOUNTY DRAIN
E0200	EAST ONONDAGA DRAIN
E0700	ELDRED DRAIN
F0800	FOWLER DRAIN
G0700	GOODNOE DRAIN
G2300	GHERE DRAIN
H0100	HAINES DRAIN
H5700	HEMANS DRAIN
K1500	KNICKERBOCKER DRAIN
M4000	MIRY CREEK
N0900	NORTH ONONDAGA DRAIN
P0300	PERRY CREEK DRAIN
P0301	PERRY CREEK EXTENSION DRAIN
P0302	PERRY CREEK TILE DRAIN
P0800	PLAINS ROAD DRAIN
P1900	PUFFENBERGER DRAIN
R1900	ROSSMAN DRAIN
S3500	SWEET DRAIN
S3800	STIMER DRAIN
S6300	STONE DRAIN
T1100	TERRY DRAIN

Date Revised: 3/12/2025