

LANSING TOWNSHIP NE, T.4N. - R.2W. , INGHAM COUNTY, MICHIGAN

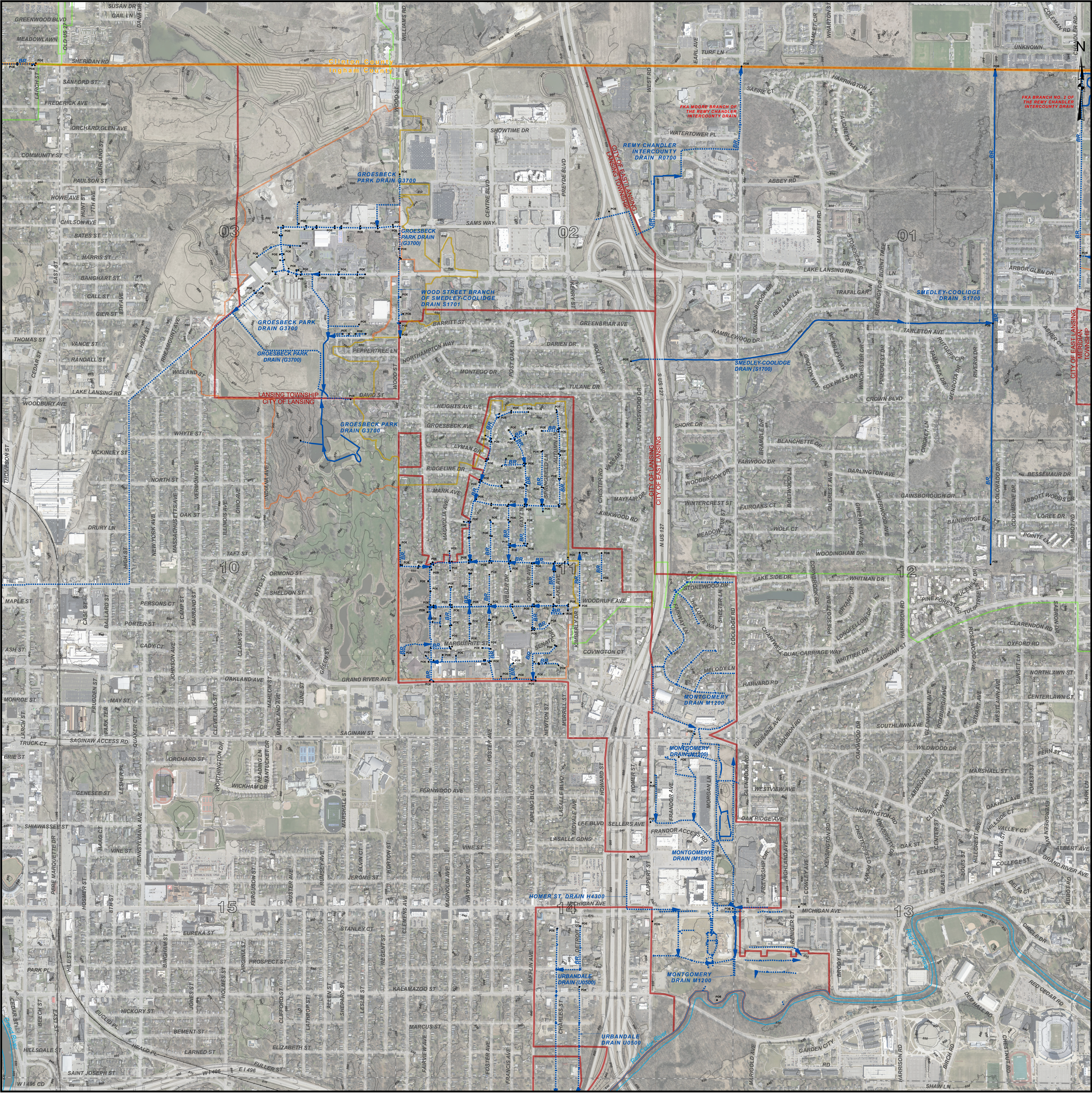

PATRICK E. LINDEMANN
INGHAM COUNTY DRAIN COMMISSIONER

PRELIMINARY

LANSING TOWNSHIP NE DRAIN MAP
T.4N. - R.2W.
INGHAM COUNTY, MICHIGAN

INGHAM COUNTY



DRAIN COMMISSIONER
PATRICK E. LINDEMANN

707 BURL AVENUE
P.O. BOX 220
MASON, MI 48854
PHONE: (517)-676-8395
FAX: (517)-676-8364

LEGEND

MUNICIPAL BOUNDARIES

SECTIONS

COUNTY

DRAINAGE DISTRICT BOUNDARIES

OTHER INTERCOUNTY DISTRICT BOUNDARIES

OPEN DRAIN

CLOSED DRAIN

ROADS

RAILROADS

NATURAL WATERCOURSE

RED = FORMERLY KNOWN AS

DISCLAIMER:

This map is a generalized representation of established drain routes and courses and/or drainage district boundaries. It is provided by the Ingham County Drain Commissioner for reference and display purposes only and does not confirm, create, refute, remove, expand, alter or otherwise affect any rights or obligations recognized or imposed by federal, state or local law, ordinance, regulation or rule.

0 0.13 0.25 0.5 Miles

1 INCH = 500 FEET

DRAIN INDEX

Drain No.	Drain Name
G3700	GROESBECK PARK DRAIN
H4300	HOMER ST. DRAIN
M1200	MONTGOMERY DRAIN
R0700	REMY CHANDLER INTERCOUNTY DRAIN
R1200	RICHARDS DRAIN
S1700	SMEDLEY-COOLIDGE DRAIN
S1701	WOOD STREET BRANCH OF SMEDLEY-COOLIDGE DRAIN
T2000	TOLLGATE DRAIN
U0500	URBANDALE DRAIN

Date Revised: 3/12/2025